



URGENT NOTICE
Wylie Homebuilders
Concrete Contractors

The Engineering/Public Works Department of the City of Wylie will be taking over all sidewalk inspections in the right of way and driveway inspections on private property, Tuesday, May 28 2019. Inspections will be requested the same way as in the past, but will be performed by Jeremy Rodriquez or other staff of the Public Works Department. You will receive an email result as usual. Jeremy's cell phone number is 214-240-5246. Building Inspections will no longer be involved in these inspections. You will continue to receive email notifications of inspection results.

Please see following pages with various changes:

- Effective Tuesday, May 28, 2019. Public Works will take over all concrete inspections in the right of way and private driveways. Request inspections as usual. If there is a rain event after you pass your inspection and before your pour, a re-inspection will be required. Thank you for your cooperation with these changes. Please contact Jeremy Rodriquez (214-240-5246) if you have further questions.
- **There will be a final right of way inspection performed by Public Works. This inspection must be PASSED BEFORE you may request your final building inspection.** Please take care of this as soon as possible, as it could affect closings. If you have colleagues in Rowlett, please discuss this process with them, as they are involved in a similar program.
- A driveway cut affidavit (attached) will be required for each address.

Please make yourself familiar with the specifications on the following pages.

CONCRETE POUR DETAILS IN CITY RIGHT OF WAY

GENERAL NOTES:

- Concrete for all streets and private developments shall be in accordance with NCTCOG, Fourth Edition or as amended Class "C" concrete (Six Sack 3,600 P.S.I. Machine, Seven Sack 4500 PSI Hand Pour, Compressive at 28 days). Item 303.3.4.2(a) and item 303.5.6.2 hand.
- Reinforcing steel shall be deformed bars No. 3 on 18 inch centers or No. 4 bars on 24 inch centers. Reinforcing shall be in both directions on center. Reinforcing steel shall be in accordance with ASTM 615, 616 and 617.
- **Any curb and/or street section removed for the construction of a private driveway shall**

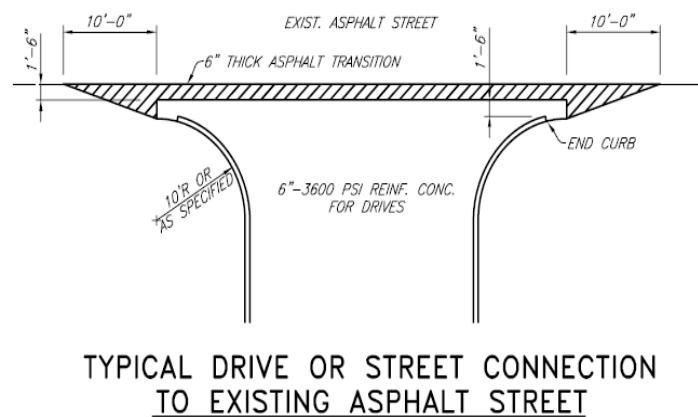
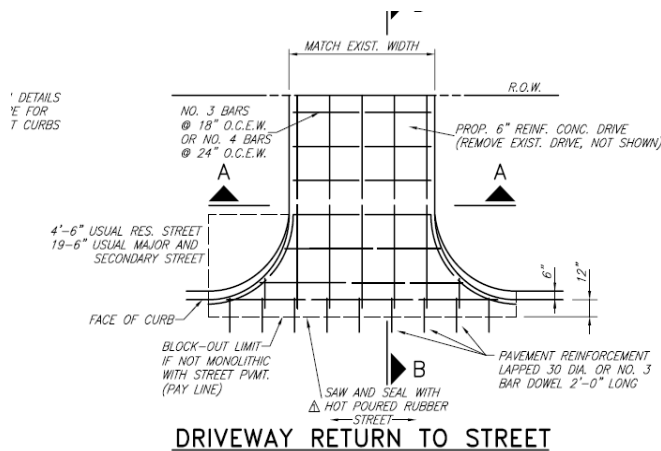

not be removed prior to 14 days of construction of the driveway. If the

driveway is not constructed within this time frame and excavation has been made, excavation shall be replaced until such time construction commences.

DOWEL BAR SCHEDULE		
SLAB DEPTH INCHES	DOWEL DIAMETER INCHES	DOWEL LENGTH INCHES
5	5/8	14
6	3/4	16
7	7/8	16
8	1	18
9	1-1/8	18

All sidewalks shall be a five sack 3000psi concrete.

All subgrade under concrete paving shall be compacted to 95% and NO cushion sand is required.

If a rain event occurs prior to concrete placement, a re-inspection is required.

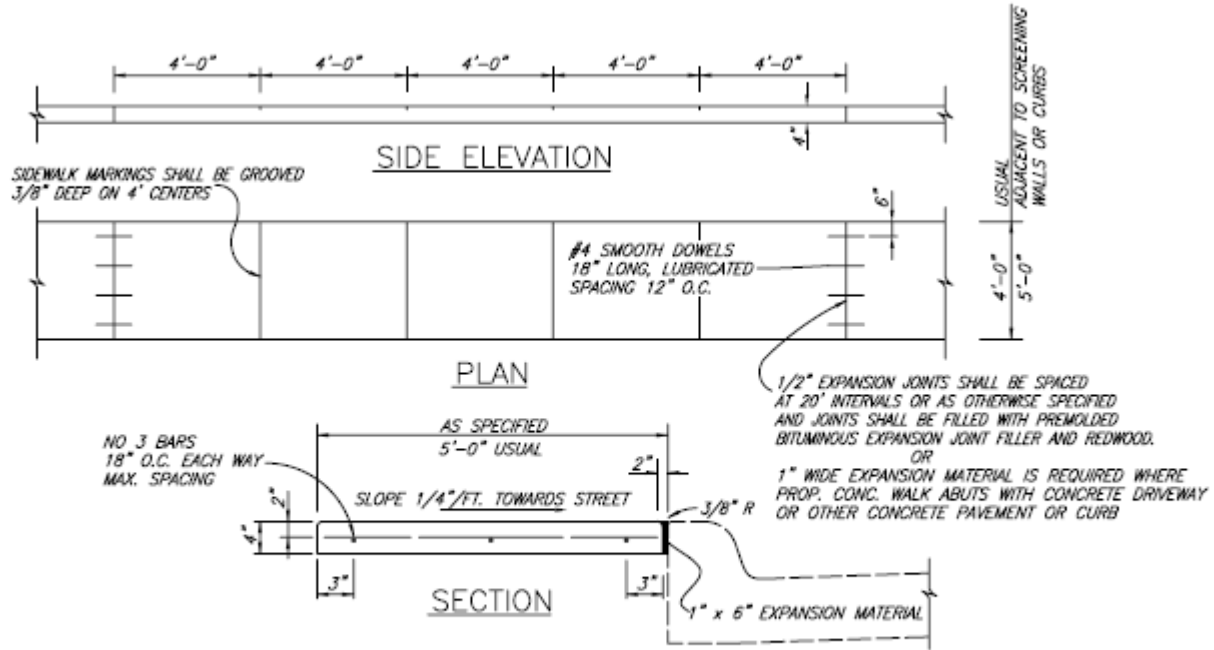

REINFORCED CONCRETE SIDEWALK

UTILITY CONNECTION IN CITY RIGHT OF WAY

General Notes:

All fill shall be compacted by mechanical methods. Maximum loose lift for compaction shall be 8 inches. All lifts shall be tested for density by an independent laboratory approved by the city. Density requirement shall be as shown on the plans for the type of material called for in the plans.

All Sanitary Sewer Services are located 10' foot back of curb.

Backfill and compaction of passing utility inspection shall be completed within 72 hours.

